

FEC1008CP Series

■ SMD Wire Wound Ceramic Chip Inductors

MECHANICAL DIMENSIONS

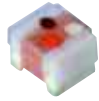

FEC1008CP

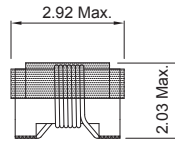

1R0~150: 2.10 Max.

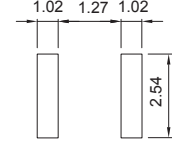
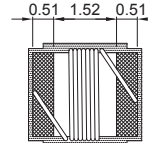
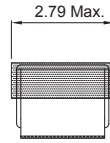

Recommended Patterns

unit: mm

ELECTRICAL SPECIFICATION

Part Number	Inductance (nH)	Inductance Tolerance	Test Freq. (MHz)	Q Min.	Test Freq. (MHz)	SRF (GHz) Min.	DCR (Ω) Max.	I _{rms} (mA)	Color Code		
									1st	2nd	multiplier
FEC1008CP-5N6□-LRH	5.6	K, J	50	50	1500	4.00	0.15	1000	GREEN	BLUE	WHITE
FEC1008CP-10N□-LRH	10	K, J	50	50	500	4.10	0.08	1000	BROWN	BLACK	BLACK
FEC1008CP-12N□-LRH	12	K, J	50	50	500	3.30	0.09	1000	BROWN	RED	BLACK
FEC1008CP-15N□-LRH	15	K, J	50	50	500	2.50	0.10	1000	BROWN	GREEN	BLACK
FEC1008CP-18N□-LRH	18	K, J, G	50	50	350	2.50	0.11	1000	BROWN	GRAY	BLACK
FEC1008CP-22N□-LRH	22	K, J, G	50	55	350	2.40	0.12	1000	RED	RED	BLACK
FEC1008CP-24N□-LRH	24	K, J, G	50	55	350	1.90	0.13	1000	RED	YELLOW	BLACK
FEC1008CP-27N□-LRH	27	K, J, G	50	55	350	1.60	0.13	1000	RED	VIOLET	BLACK
FEC1008CP-33N□-LRH	33	K, J, G	50	60	350	1.60	0.14	1000	ORANGE	ORANGE	BLACK
FEC1008CP-36N□-LRH	36	K, J, G	50	60	350	1.60	0.15	1000	ORANGE	BLUE	BLACK
FEC1008CP-39N□-LRH	39	K, J, G	50	60	350	1.50	0.15	1000	ORANGE	WHITE	BLACK
FEC1008CP-47N□-LRH	47	K, J, G	50	65	350	1.50	0.16	1000	YELLOW	VIOLET	BLACK
FEC1008CP-56N□-LRH	56	K, J, G	50	65	350	1.30	0.18	1000	GREEN	BLUE	BLACK
FEC1008CP-62N□-LRH	62	K, J, G	25	45	350	1.25	0.20	1000	BLUE	RED	BLACK
FEC1008CP-68N□-LRH	68	K, J, G	50	65	350	1.30	0.20	1000	BLUE	GRAY	BLACK
FEC1008CP-75N□-LRH	75	K, J, G	50	60	350	1.10	0.21	1000	VIOLET	GREEN	BLACK
FEC1008CP-82N□-LRH	82	K, J, G	50	60	350	1.00	0.22	1000	GRAY	RED	BLACK
FEC1008CP-91N□-LRH	91	K, J, G	50	50	350	1.00	0.45	1000	WHITE	BROWN	BLACK
FEC1008CP-R10□-LRH	100	K, J, G	25	60	350	1.00	0.56	650	BROWN	BLACK	BROWN
FEC1008CP-R12□-LRH	120	K, J, G	25	60	350	0.950	0.63	650	BROWN	RED	BROWN
FEC1008CP-R15□-LRH	150	K, J, G	25	45	100	0.850	0.70	580	BROWN	GREEN	BROWN
FEC1008CP-R18□-LRH	180	K, J, G	25	45	100	0.750	0.77	620	BROWN	GRAY	BROWN
FEC1008CP-R20□-LRH	200	K, J, G	25	50	100	0.750	0.81	500	RED	BLACK	BROWN
FEC1008CP-R22□-LRH	220	K, J, G	25	45	100	0.700	0.84	500	RED	RED	BROWN
FEC1008CP-R24□-LRH	240	K, J, G	25	50	100	0.650	0.84	500	RED	YELLOW	BROWN
FEC1008CP-R27□-LRH	270	K, J, G	25	45	100	0.600	0.91	500	RED	VIOLET	BROWN
FEC1008CP-R30□-LRH	300	K, J, G	25	45	100	0.590	1.00	660	ORANGE	BLACK	BROWN
FEC1008CP-R33□-LRH	330	K, J, G	25	45	100	0.570	1.05	450	ORANGE	ORANGE	BROWN
FEC1008CP-R36□-LRH	360	K, J, G	25	45	100	0.530	1.05	660	ORANGE	BLUE	BROWN
FEC1008CP-R39□-LRH	390	K, J, G	25	45	100	0.500	1.12	470	ORANGE	WHITE	BROWN
FEC1008CP-R43□-LRH	430	K, J, G	25	45	100	0.480	1.15	600	YELLOW	ORANGE	BROWN
FEC1008CP-R47□-LRH	470	K, J, G	25	45	100	0.450	1.19	470	YELLOW	VIOLET	BROWN
FEC1008CP-R56□-LRH	560	K, J, G	25	45	100	0.415	1.33	400	GREEN	BLUE	BROWN
FEC1008CP-R62□-LRH	620	K, J, G	25	45	100	0.375	1.40	300	BLUE	RED	BROWN
FEC1008CP-R68□-LRH	680	K, J, G	25	45	100	0.375	1.47	400	BLUE	GRAY	BROWN
FEC1008CP-R75□-LRH	750	K, J, G	25	45	100	0.360	1.54	360	VIOLET	GREEN	BROWN
FEC1008CP-R82□-LRH	820	K, J, G	25	45	100	0.350	1.61	400	GRAY	RED	BROWN
FEC1008CP-R91□-LRH	910	K, J, G	25	35	50	0.320	1.68	380	WHITE	BROWN	BROWN
FEC1008CP-1R0□-LRH	1000	K, J, G	25	35	50	0.290	1.75	370	BROWN	BLACK	RED
FEC1008CP-1R2□-LRH	1200	K, J, G	7.9	35	50	0.250	2.00	310	BROWN	RED	RED
FEC1008CP-1R5□-LRH	1500	K, J, G	7.9	28	50	0.200	2.30	330	BROWN	GREEN	RED
FEC1008CP-1R8□-LRH	1800	K, J, G	7.9	28	50	0.160	2.60	300	BROWN	GRAY	RED
FEC1008CP-2R0□-LRH	2000	K, J, G	7.9	25	50	0.160	2.80	280	RED	BLACK	RED
FEC1008CP-2R2□-LRH	2200	K, J, G	7.9	28	50	0.160	2.80	280	RED	RED	RED
FEC1008CP-2R7□-LRH	2700	K, J, G	7.9	22	25	0.140	3.20	290	RED	VIOLET	RED
FEC1008CP-3R3□-LRH	3300	K, J, G	7.9	22	25	0.110	3.40	290	ORANGE	ORANGE	RED
FEC1008CP-3R9□-LRH	3900	K, J, G	7.9	20	25	0.100	3.60	260	ORANGE	WHITE	RED
FEC1008CP-4R7□-LRH	4700	K, J, G	7.9	20	25	0.090	4.00	260	YELLOW	VIOLET	RED
FEC1008CP-5R6□-LRH	5600	K, J	7.9	16	7.96	0.020	4.00	240	GREEN	BLUE	RED

SMD

Leaded

FEC1008CP Series

■ SMD Wire Wound Ceramic Chip Inductors

ELECTRICAL SPECIFICATION

Part Number	Inductance (nH)	Inductance Tolerance	Test Freq. (MHz)	Q Min.	Test Freq. (MHz)	SRF (GHz) Min.	DCR (Ω) Max.	I _{rms} (mA)	Color Code		
									1st	2nd	multiplier
FEC1008CP-6R8□-LRH	6800	K, J	7.9	15	7.96	0.040	4.90	200	BLUE	GRAY	RED
FEC1008CP-8R2□-LRH	8200	K, J	7.9	15	7.96	0.025	6.00	170	GRAY	RED	RED
FEC1008CP-100□-LRH	10000	K, J	2.52	15	7.96	0.020	9.00	150	BROWN	BLACK	ORANGE
FEC1008CP-120□-LRH	12000	K, J	2.52	15	7.96	0.018	10.50	130	BROWN	RED	ORANGE
FEC1008CP-150□-LRH	15000	K, J	2.52	15	7.96	0.015	11.50	120	BROWN	GREEN	ORANGE

- External electrode: FEC1008CP (Sn-plating), FEC1008C (Au-plating)
- Tolerance: K=±10% ; J=±5% ; G=±2%
- Operating Temp: -40°C to +125°C
- For 15°C Temperature Rise.
- Inductance & Q measured using the HP4291B.
- SRF measured using the HP8753E or HP8720D.
- DCR measured using the 16502BC milli-ohm meter.
- Unspecified values available on request.

CHARACTERISTIC CURVE

FEC1008CP Series

