

CSS1050G Series (SHIELDED)

■ SMD Wire Wound Power Inductors

MECHANICAL DIMENSIONS



CSS1050G

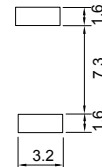
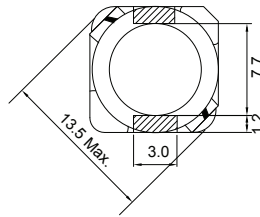
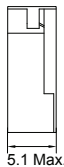
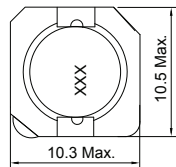

Recommended Patterns

unit: mm

ELECTRICAL SPECIFICATION

Part Number	Marking	Inductance (μH)	Test Freq. (KHz)	DCR (mΩ) Max.	Rated Current (A)	Isat (A)
CSS1050G-R80N-LRH	R80	0.80	100	4.3	9.50	13.5
CSS1050G-1R5N-LRH	1R5	1.50	100	5.8	8.30	10.5
CSS1050G-2R2N-LRH	2R2	2.20	100	7.2	7.50	9.25
CSS1050G-3R3N-LRH	3R3	3.30	100	10.4	6.50	7.80
CSS1050G-4R7N-LRH	4R7	4.70	100	12.3	6.10	6.40
CSS1050G-6R8N-LRH	6R8	6.80	100	18.0	5.40	5.40
CSS1050G-8R2N-LRH	8R2	8.20	100	20.0	5.00	4.85
CSS1050G-100N-LRH	100	10.0	100	26.0	4.50	4.45
CSS1050G-120N-LRH	120	12.0	100	33.0	3.80	4.00
CSS1050G-150N-LRH	150	15.0	100	41.0	3.40	3.60
CSS1050G-180N-LRH	180	18.0	100	46.0	3.10	3.20
CSS1050G-220N-LRH	220	22.0	100	61.0	2.90	2.95
CSS1050G-270N-LRH	270	27.0	100	69.0	2.60	2.70
CSS1050G-330N-LRH	330	33.0	100	84.0	2.50	2.40
CSS1050G-390N-LRH	390	39.0	100	106.0	2.25	2.30
CSS1050G-470N-LRH	470	47.0	100	130.0	2.00	2.00
CSS1050G-560N-LRH	560	56.0	100	149.0	1.90	1.90
CSS1050G-680N-LRH	680	68.0	100	201.0	1.60	1.65
CSS1050G-820N-LRH	820	82.0	100	227.0	1.45	1.50
CSS1050G-101N-LRH	101	100	100	253.0	1.35	1.35
CSS1050G-121N-LRH	121	120	100	303.0	1.18	1.28
CSS1050G-151N-LRH	151	150	100	370.0	1.10	1.12
CSS1050G-181N-LRH	181	180	100	419.0	1.00	1.04
CSS1050G-221N-LRH	221	220	100	500.0	0.94	0.94
CSS1050G-271N-LRH	271	270	100	672.0	0.80	0.84
CSS1050G-331N-LRH	331	330	100	812.0	0.73	0.75
CSS1050G-391N-LRH	391	390	100	953.0	0.70	0.70
CSS1050G-471N-LRH	471	470	100	1289	0.54	0.60
CSS1050G-561N-LRH	561	560	100	1430	0.52	0.54
CSS1050G-681N-LRH	681	680	100	1599	0.51	0.52
CSS1050G-821N-LRH	821	820	100	1768	0.48	0.50
CSS1050G-102N-LRH	102	1000	100	1989	0.42	0.48

- Tolerance: N= ±30% ; M= ±20%
- Operating Temperature Range: -30°C to +100°C (Including self-generated heat)
- Inductance measured using the HP4284A ; Chroma3302+1320
- DCR measured using the 16502 milli-ohm meter
- Inductance drop no more than 35% of initial value at Isat, temperature rises Δ t<40°C at rated current.
- Storage Temperature Range: -40°C to +85°C

CHARACTERISTIC CURVE

CSS1050G Series

