

# CSS0628P Series (SHIELDED)

## ■ SMD Wire Wound Power Inductors

### MECHANICAL DIMENSIONS

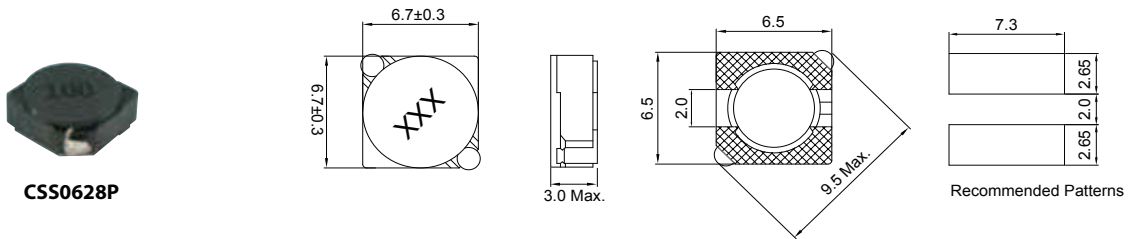

### ELECTRICAL SPECIFICATION

Part Number	Marking	Inductance (μH)	Test Freq. (KHz)	DCR (mΩ) Max.	Rated Current (A)
CSS0628P-3R0N-LRH	3R0	3.0	10	24	3.00
CSS0628P-3R9N-LRH	3R9	3.9	10	27	2.60
CSS0628P-5R0N-LRH	5R0	5.0	10	31	2.40
CSS0628P-6R0N-LRH	6R0	6.0	10	35	2.25
CSS0628P-7R3N-LRH	7R3	7.3	10	54	2.10
CSS0628P-8R6N-LRH	8R6	8.6	10	58	1.85
CSS0628P-100N-LRH	100	10	10	65	1.70
CSS0628P-120N-LRH	120	12	10	70	1.55
CSS0628P-150N-LRH	150	15	10	84	1.40
CSS0628P-180N-LRH	180	18	10	95	1.32
CSS0628P-220N-LRH	220	22	10	128	1.20
CSS0628P-270N-LRH	270	27	10	142	1.05
CSS0628P-330N-LRH	330	33	10	165	0.97
CSS0628P-390N-LRH	390	39	10	210	0.86
CSS0628P-470N-LRH	470	47	10	238	0.80
CSS0628P-560N-LRH	560	56	10	277	0.73
CSS0628P-680N-LRH	680	68	10	304	0.65
CSS0628P-820N-LRH	820	82	10	390	0.60
CSS0628P-101N-LRH	101	100	10	535	0.54

- Tolerance: N=±30% ; M=±20% ; L=±15%
- Operating Temperature Range: -30°C to +100°C (Including self-generated heat)
- Inductance measured using the HP4284A ; Chroma3302+1320
- DCR measured using the 16502 milli-ohm meter
- Inductance drop no more than 35% of initial value at Isat, temperature rises  $\Delta t < 40^\circ\text{C}$  at rated current.
- Storage Temperature Range: -40°C to +85°C

### CHARACTERISTIC CURVE

#### CSS0628P Series

