

# CSS0316P Series (SHIELDED)

## ■ SMD Wire Wound Power Inductors

### MECHANICAL DIMENSIONS



CSS0316P

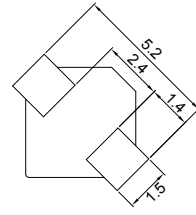
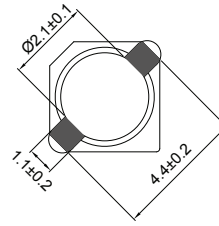
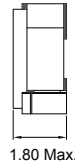
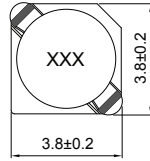

Recommended Patterns

unit: mm

### ELECTRICAL SPECIFICATION

Part Number	Marking	Inductance (μH)	Test Freq. (KHz)	DCR (mΩ) Max.	Rated Current (mA)
CSS0316P-1R5N-LRH	1R5	1.5	100	52	1550
CSS0316P-2R2N-LRH	2R2	2.2	100	72	1200
CSS0316P-3R3N-LRH	3R3	3.3	100	85	1100
CSS0316P-4R7N-LRH	4R7	4.7	100	105	900
CSS0316P-6R8N-LRH	6R8	6.8	100	170	730
CSS0316P-100N-LRH	100	10.0	100	210	550
CSS0316P-150N-LRH	150	15.0	100	295	450
CSS0316P-220N-LRH	220	22.0	100	430	400
CSS0316P-330N-LRH	330	33.0	100	675	320

- Tolerance: N= ±30% ; M= ±20% ; L= ±15%
- Operating Temperature Range: -30°C to +100°C (Including self-generated heat)
- Inductance measured using the HP4284A ; Chroma3302+1320
- DCR measured using the 16502 milli-ohm meter
- Inductance drop no more than 35% of initial value at Isat, temperature rises Δ t<40°C at rated current.
- Storage Temperature Range: -40°C to +85°C

### CHARACTERISTIC CURVE

#### CSS0316P Series

