

CSN105D Series (UNSHIELDED)

■ SMD Wire Wound Power Inductors

MECHANICAL DIMENSIONS



CSN105D

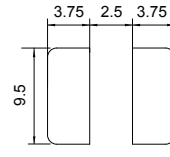
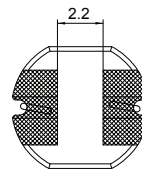
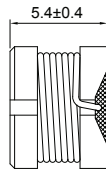
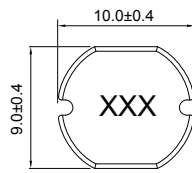

Recommended Patterns

unit: mm

ELECTRICAL SPECIFICATION

| Part Number | Marking | Inductance (μH) | Test Freq. (KHz) | DCR (Ω) Max. | Rated Current (A) |
|------------------|---------|-----------------|------------------|--------------|-------------------|
| CSN105D-100M-LRH | 100 | 10 | 100 | 0.06 | 2.60 |
| CSN105D-120M-LRH | 120 | 12 | 100 | 0.07 | 2.45 |
| CSN105D-150M-LRH | 150 | 15 | 100 | 0.08 | 2.27 |
| CSN105D-180M-LRH | 180 | 18 | 100 | 0.09 | 2.15 |
| CSN105D-220M-LRH | 220 | 22 | 100 | 0.10 | 1.95 |
| CSN105D-270M-LRH | 270 | 27 | 100 | 0.11 | 1.76 |
| CSN105D-330M-LRH | 330 | 33 | 100 | 0.12 | 1.50 |
| CSN105D-390M-LRH | 390 | 39 | 100 | 0.14 | 1.37 |
| CSN105D-470K-LRH | 470 | 47 | 100 | 0.17 | 1.28 |
| CSN105D-560K-LRH | 560 | 56 | 100 | 0.19 | 1.17 |
| CSN105D-680K-LRH | 680 | 68 | 100 | 0.22 | 1.11 |
| CSN105D-820K-LRH | 820 | 82 | 100 | 0.25 | 1.00 |
| CSN105D-101K-LRH | 101 | 100 | 10 | 0.35 | 0.97 |
| CSN105D-121K-LRH | 121 | 120 | 10 | 0.40 | 0.89 |
| CSN105D-151K-LRH | 151 | 150 | 10 | 0.47 | 0.78 |
| CSN105D-181K-LRH | 181 | 180 | 10 | 0.63 | 0.72 |
| CSN105D-221K-LRH | 221 | 220 | 10 | 0.73 | 0.66 |
| CSN105D-271K-LRH | 271 | 270 | 10 | 0.97 | 0.57 |
| CSN105D-331K-LRH | 331 | 330 | 10 | 1.15 | 0.52 |
| CSN105D-391K-LRH | 391 | 390 | 10 | 1.30 | 0.48 |
| CSN105D-471K-LRH | 471 | 470 | 10 | 1.48 | 0.42 |
| CSN105D-561K-LRH | 561 | 560 | 10 | 1.90 | 0.33 |
| CSN105D-681K-LRH | 681 | 680 | 10 | 2.25 | 0.28 |
| CSN105D-821K-LRH | 821 | 820 | 10 | 2.55 | 0.24 |

- Tolerance: M=±20% ; L=±15% ; K=±10%
- Operating Temperature Range: -30°C to +100°C (Including self-generated heat)
- Inductance measured using the HP4284A ; Chroma 3302+1320
- DCR measured using the 16502 milli-ohm meter
- Inductance drop no more than 10% of initial value at rated current ,temperature rises $\Delta t < 40^{\circ}\text{C}$
- Storage Temperature Range: -40°C to +85°C

CHARACTERISTIC CURVE

CSN105D Series

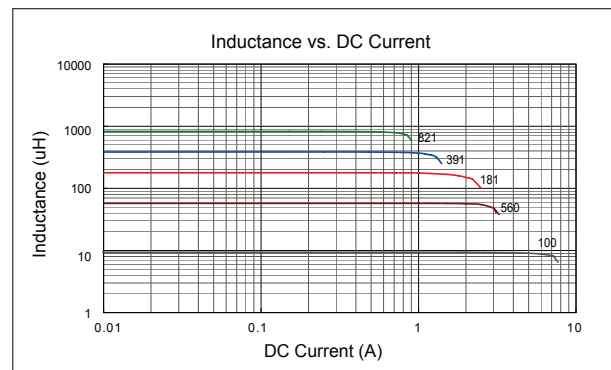
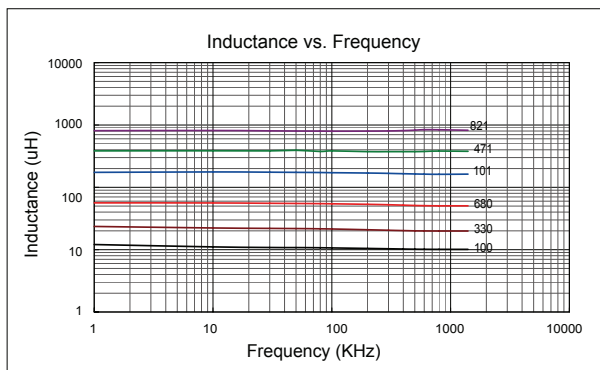

SMD

Leaded