

CSM0315D Series (SHIELDED)

■ SMD Wire Wound Power Inductors

MECHANICAL DIMENSIONS

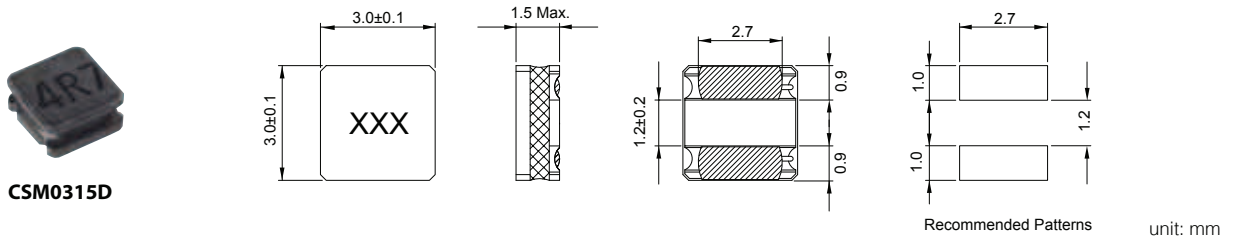

ELECTRICAL SPECIFICATION

Part Number	Marking	Inductance (μH)	Test Freq. (MHz)	DCR (Ω)	Isat (A)	Irms (A)	Inductance Tolerance
				Max.	Max.	Max.	
CSM0315D-1R0N-LRH	1R0	1.00	1	0.048	2.10	2.10	M: ±20% N: ±30%
CSM0315D-1R5N-LRH	1R5	1.50	1	0.066	1.80	1.90	
CSM0315D-1R8M-LRH	1R8	1.80	1	0.065	1.75	1.70	
CSM0315D-2R2M-LRH	2R2	2.20	1	0.072	1.48	1.60	
CSM0315D-3R3M-LRH	3R3	3.30	1	0.112	1.21	1.45	
CSM0315D-4R7M-LRH	4R7	4.70	1	0.136	1.08	1.25	
CSM0315D-5R1M-LRH	5R1	5.10	1	0.1625	1.08	1.09	
CSM0315D-6R8M-LRH	6R8	6.80	1	0.211	0.90	0.90	
CSM0315D-100M-LRH	100	10.0	1	0.267	0.75	0.87	
CSM0315D-120M-LRH	120	12.0	1	0.416	0.70	0.68	
CSM0315D-150M-LRH	150	15.0	1	0.422	0.58	0.65	
CSM0315D-180M-LRH	180	18.0	1	0.559	0.56	0.59	
CSM0315D-220M-LRH	220	22.0	1	0.598	0.47	0.55	
CSM0315D-330M-LRH	330	33.0	1	0.959	0.39	0.45	
CSM0315D-470M-LRH	470	47.0	1	1.406	0.32	0.40	
CSM0315D-560M-LRH	560	56.0	1	1.664	0.33	0.34	
CSM0315D-101M-LRH	101	100	1	2.920	0.23	0.25	

- Tolerance: N= ± 30% ; M= ± 20%
- Test Equipment:
L/Q: CHROMA CH-3302, HP 4286A or equivalent.
RDC: CHROMA 16502 or equivalent.
- Isat: Based on Inductance decrease 30% (at 20°C)
- Iirms: Based on Temperature increase 40°C (at 20°C)
- Operating temperature Range: -40°C to +125°C (Including self-temperature rise)
- Storage Temp.: -40°C to +85°C

CHARACTERISTIC CURVE

CSM0315D Series

