

# CP0908BI/M Series

## Wire Wound Choke Coils

### MECHANICAL DIMENSIONS



CP0908BI/M

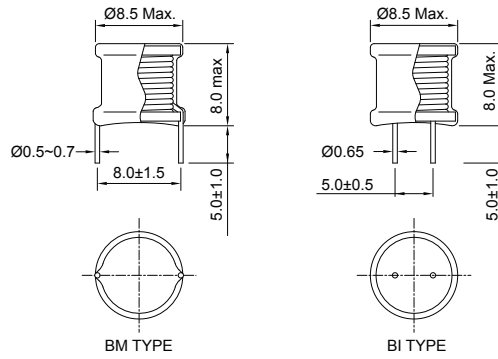

unit: mm

### ELECTRICAL SPECIFICATION

| Part Number    | Inductance<br>@1KHz<br>( $\mu$ H) | Q<br>Min. | Test Freq.<br>(KHz) | SRF<br>(MHz)<br>Min. | DCR<br>( $\Omega$ )<br>Max. | Rated Current<br>(Amps.)<br>Max. |
|----------------|-----------------------------------|-----------|---------------------|----------------------|-----------------------------|----------------------------------|
| CP0908BM-1R0MH | 1.0                               | 20        | 7.90                | 68                   | 0.005                       | 7.50                             |
| CP0908BM-1R5MH | 1.5                               | 20        | 7.90                | 56                   | 0.008                       | 6.60                             |
| CP0908BM-2R2MH | 2.2                               | 20        | 7.90                | 45                   | 0.010                       | 5.40                             |
| CP0908BM-3R3MH | 3.3                               | 20        | 7.90                | 38                   | 0.013                       | 4.50                             |
| CP0908BM-4R7MH | 4.7                               | 20        | 7.90                | 30                   | 0.017                       | 3.70                             |
| CP0908BM-6R8MH | 6.8                               | 20        | 7.90                | 24                   | 0.022                       | 3.10                             |
| CP0908BM-100KH | 10                                | 20        | 2.50                | 19                   | 0.03                        | 2.50                             |
| CP0908BM-120KH | 12                                | 20        | 2.50                | 17                   | 0.04                        | 2.20                             |
| CP0908BM-150KH | 15                                | 20        | 2.50                | 15                   | 0.05                        | 2.00                             |
| CP0908BI-180KH | 18                                | 20        | 2.50                | 13                   | 0.06                        | 1.80                             |
| CP0908BI-220KH | 22                                | 20        | 2.50                | 12                   | 0.07                        | 1.60                             |
| CP0908BI-270KH | 27                                | 20        | 2.50                | 11                   | 0.08                        | 1.40                             |
| CP0908BI-330KH | 33                                | 20        | 2.50                | 10                   | 0.10                        | 1.30                             |
| CP0908BI-390KH | 39                                | 20        | 2.50                | 9.0                  | 0.12                        | 1.20                             |
| CP0908BI-470KH | 47                                | 20        | 2.50                | 8.0                  | 0.14                        | 1.10                             |
| CP0908BI-560KH | 56                                | 20        | 2.50                | 7.0                  | 0.16                        | 0.96                             |
| CP0908BI-680KH | 68                                | 20        | 2.50                | 6.5                  | 0.18                        | 0.91                             |
| CP0908BI-820KH | 82                                | 20        | 2.50                | 6.0                  | 0.20                        | 0.83                             |
| CP0908BI-101KH | 100                               | 15        | 0.79                | 5.5                  | 0.25                        | 0.75                             |
| CP0908BI-121KH | 120                               | 15        | 0.79                | 5.0                  | 0.33                        | 0.68                             |
| CP0908BI-151KH | 150                               | 15        | 0.79                | 4.5                  | 0.40                        | 0.61                             |
| CP0908BI-181KH | 180                               | 15        | 0.79                | 4.0                  | 0.50                        | 0.55                             |
| CP0908BI-221KH | 220                               | 15        | 0.79                | 3.5                  | 0.60                        | 0.50                             |
| CP0908BI-271KH | 270                               | 15        | 0.79                | 3.2                  | 0.70                        | 0.45                             |
| CP0908BI-331KH | 330                               | 15        | 0.79                | 2.8                  | 0.80                        | 0.41                             |
| CP0908BI-391KH | 390                               | 15        | 0.79                | 2.5                  | 0.90                        | 0.37                             |
| CP0908BI-471KH | 470                               | 15        | 0.79                | 2.3                  | 1.0                         | 0.34                             |
| CP0908BI-561KH | 560                               | 15        | 0.79                | 2.1                  | 1.3                         | 0.31                             |
| CP0908BI-681KH | 680                               | 15        | 0.79                | 1.9                  | 1.5                         | 0.28                             |
| CP0908BI-821KH | 820                               | 15        | 0.79                | 1.7                  | 2.0                         | 0.25                             |
| CP0908BI-102KH | 1000                              | 30        | 0.25                | 1.5                  | 2.5                         | 0.23                             |
| CP0908BI-122KH | 1200                              | 30        | 0.25                | 1.3                  | 3.0                         | 0.20                             |
| CP0908BI-152KH | 1500                              | 30        | 0.25                | 1.2                  | 3.5                         | 0.18                             |

• Tolerance: M  $\pm$  20% ; L  $\pm$  15% ; K  $\pm$  10%  
 • Test Equipment:  
 L: HP 4285A LCR meter or equivalent.  
 Q: HP 4285A at specified freq. or equivalent.  
 RDC: CHROMA-16502 or equivalent.  
 SRF: HP4291B or equivalent.

• Operating temperature: -40°C to +85°C (Including self-temperature rise)  
 • Temperature rise 25°C Max.  
 • Ambient temperature: 60°C Max.

SMD

Leaded