

CP0808AI/M Series

■ Wire Wound Choke Coils

MECHANICAL DIMENSIONS



CP0808AI/M

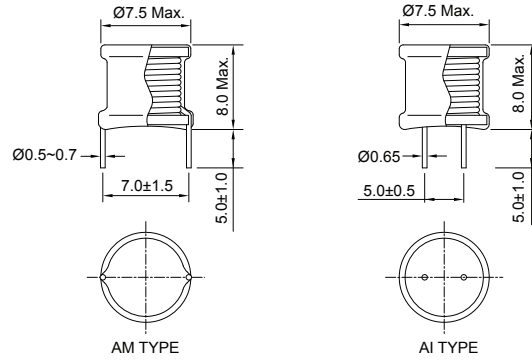

unit: mm

ELECTRICAL SPECIFICATION

Part Number	Inductance @1KHz (μ H)	Q Min.	Test Freq. (KHz)	SRF (MHz) Min.	DCR (Ω) Max.	Rated Current (Amps.) Max.
CP0808AM-1R0MH	1.0	20	7.90	70	0.007	6.60
CP0808AM-1R5MH	1.5	20	7.90	60	0.010	5.40
CP0808AM-2R2MH	2.2	20	7.90	45	0.015	4.50
CP0808AM-3R3MH	3.3	20	7.90	35	0.020	3.60
CP0808AM-4R7MH	4.7	20	7.90	30	0.025	3.10
CP0808AM-6R8MH	6.8	20	7.90	25	0.030	2.50
CP0808AI-100KH	10	20	2.50	20	0.045	2.10
CP0808AI-120KH	12	20	2.50	17	0.050	1.90
CP0808AI-150KH	15	20	2.50	15	0.065	1.70
CP0808AI-180KH	18	20	2.50	13	0.08	1.50
CP0808AI-220KH	22	20	2.50	12	0.10	1.40
CP0808AI-270KH	27	20	2.50	10	0.12	1.20
CP0808AI-330KH	33	20	2.50	9.2	0.14	1.10
CP0808AI-390KH	39	20	2.50	8.5	0.17	1.00
CP0808AI-470KH	47	20	2.50	7.5	0.21	0.95
CP0808AI-560KH	56	20	2.50	7.0	0.24	0.80
CP0808AI-680KH	68	20	2.50	6.5	0.28	0.75
CP0808AI-820KH	82	20	2.50	5.5	0.31	0.70
CP0808AI-101KH	100	20	0.79	5.0	0.35	0.65
CP0808AI-121KH	120	20	0.79	4.5	0.45	0.60
CP0808AI-151KH	150	20	0.79	4.0	0.56	0.53
CP0808AI-181KH	180	20	0.79	3.5	0.65	0.48
CP0808AI-221KH	220	20	0.79	3.2	0.72	0.44
CP0808AI-271KH	270	20	0.79	2.8	0.86	0.40
CP0808AI-331KH	330	20	0.79	2.5	1.10	0.36
CP0808AI-391KH	390	20	0.79	2.2	1.50	0.33
CP0808AI-471KH	470	20	0.79	2.0	1.70	0.30
CP0808AI-561KH	560	20	0.79	1.8	2.00	0.27
CP0808AI-681KH	680	20	0.79	1.7	2.50	0.25
CP0808AI-821KH	820	20	0.79	1.5	3.00	0.22
CP0808AI-102KH	1000	50	0.25	1.3	4.50	0.20

- Tolerance: M \pm 20% ; L \pm 15% ; K \pm 10%
- Test Equipment:
L: HP 4285A LCR meter or equivalent.
Q: HP 4285A at specified freq. or equivalent.
RDC: CHROMA-16502 or equivalent.
SRF: HP4291B or equivalent.

- Operating temperature: -40°C to +85°C (Including self-temperature rise)
- Temperature rise 25°C Max.
- Ambient temperature: 60°C Max.

SMD

Leaded