

0805F Series

■ SMD Wire Wound Ferrite Chip Inductors

MECHANICAL DIMENSIONS



0805F

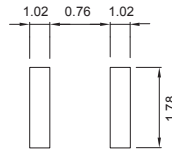
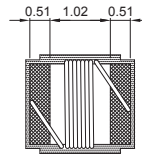
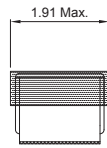
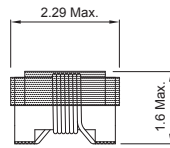

Recommended Patterns

unit: mm

ELECTRICAL SPECIFICATION

Part Number	Inductance (μH)	Inductance Tolerance	Test Freq. (MHz)	Q (min.)	Test Freq. (MHz)	SRF (GHz) Min.	DCR (Ω) Max.	I _{rms} (mA)	Color Code
0805F-78N □ -LRH	0.078	K, J	7.9	19	7.9	1.44	0.042	2000	BLACK
0805F-R11 □ -LRH	0.110	K, J	7.9	19	7.9	1.40	0.050	2000	BROWN
0805F-R18 □ -LRH	0.180	K, J	7.9	15	7.9	1.00	0.15	500	GRAY
0805F-R22 □ -LRH	0.220	K, J	7.9	15	7.9	1.00	0.15	500	VIOLET
0805F-R33 □ -LRH	0.330	K, J	7.9	15	7.9	0.862	0.25	300	WHITE
0805F-R39 □ -LRH	0.390	K, J	7.9	15	7.9	0.800	0.30	500	BLACK
0805F-R47 □ -LRH	0.470	K, J	7.9	19	7.9	0.500	0.31	720	RED
0805F-R56 □ -LRH	0.560	K, J	7.9	12	7.9	0.800	1.20	300	RED
0805F-R68 □ -LRH	0.680	K, J	7.9	20	7.9	0.400	0.46	590	ORANGE
0805F-R82 □ -LRH	0.820	K, J	7.9	12	7.9	0.600	1.00	300	YELLOW
0805F-1R0 □ -LRH	1.00	K, J	7.9	20	7.9	0.340	0.69	500	YELLOW
0805F-1R2 □ -LRH	1.20	K, J	7.9	20	7.9	0.400	0.75	800	BLACK
0805F-1R5 □ -LRH	1.50	K, J	7.9	20	7.9	0.275	0.83	490	GREEN
0805F-1R8 □ -LRH	1.80	K, J	7.9	20	7.9	0.246	1.15	410	BLUE
0805F-2R2 □ -LRH	2.20	K, J	7.9	20	7.9	0.106	1.28	365	VIOLET
0805F-2R7 □ -LRH	2.70	K, J	7.9	20	7.9	0.105	1.48	350	GRAY
0805F-3R3 □ -LRH	3.30	K, J	7.9	20	7.9	0.083	1.57	330	WHITE
0805F-3R9 □ -LRH	3.90	K, J	7.9	20	7.9	0.052	1.70	300	BLACK
0805F-4R7 □ -LRH	4.70	K, J	7.9	20	7.9	0.050	1.87	280	BROWN
0805F-5R6 □ -LRH	5.60	K, J	7.9	18	7.9	0.040	2.00	270	BLUE
0805F-6R8 □ -LRH	6.80	K, J	7.9	20	7.9	0.035	2.25	260	RED
0805F-8R2 □ -LRH	8.20	K, J	2.5	18	2.5	0.027	2.55	250	ORANGE
0805F-100 □ -LRH	10.0	K, J	2.5	18	2.5	0.021	3.45	200	YELLOW
0805F-120 □ -LRH	12.0	K, J	2.5	18	2.5	0.037	3.80	220	BROWN
0805F-150 □ -LRH	15.0	K, J	2.5	18	2.5	0.017	5.03	180	GREEN
0805F-180 □ -LRH	18.0	K, J	2.5	18	2.5	0.023	4.48	180	ORANGE
0805F-220 □ -LRH	22.0	K, J	2.5	18	2.5	0.013	6.18	150	BLUE
0805F-270 □ -LRH	27.0	K, J	2.5	15	2.5	0.011	11.04	120	VIOLET

- Tolerance: K= ± 10% ; J= ± 5%
- Operating Temp: -40°C to +85°C
- For 15°C Temperature Rise.
- Inductance & Q measured using the HP4291B.
- SRF measured using the HP8753E or HP8720D.
- DCR measured using the 16502 milli-ohm meter.
- Unspecified values available on request.

CHARACTERISTIC CURVE

0805F Series

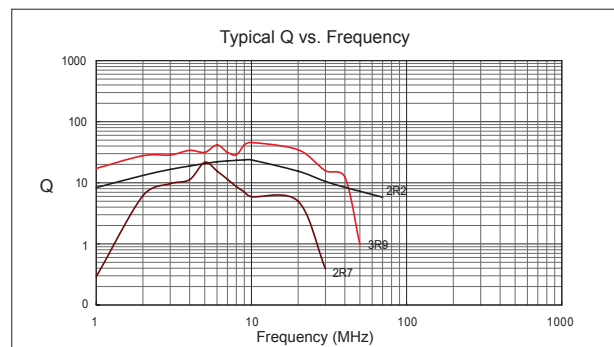
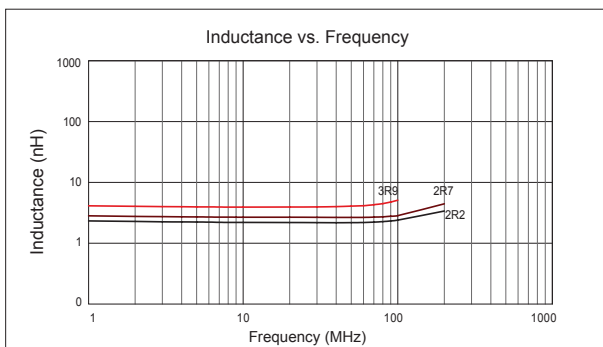

SMD

Leaded