

Short Form Specification

Beck Compact Module SCMT15X02-R RGB/DVI



January 2017

Preliminary

The information given in this document is carefully checked and believed to be reliable. However, Beck GmbH & Co. Elektronik Bauelemente KG takes no responsibility for any failure or product damage caused by application of this information. Please check all connections carefully with the product specification.

Products of Beck Elektronik are not intended for use in systems in which failures of product could result in personal injury. All mentioned trademarks are registered trademarks of their owner.

This specification is subject to change without notification.

1. General Features

Item	Description	Unit
Diagonal	38.1 (15.0")	cm
Active area	304.1 (H) x 228.1 (V)	mm
Resolution – display	1024 (x3) x 768	pixel
Resolution – controller	640 x 480 – 1024 x 768	pixel
Pixel pitch	0.297 (per one traid) X 0.297	mm
Pixel arrangement	R.G.B. vertical stripe	
Display colors	16,2 M	colors
Display mode	Normally White	
Brightness	360	cd/m ²
Contrast ratio	700:1	
Viewing angle	hor.: 80° / 80°, ver.: 70° / 70°	deg.
Response time	16	msec
LED Backlight life	min 50,000	hrs
Interface	Analog-RGB H-Sync. / V-Sync. // DVI	
Touch	PCAP / USB	
Power input voltage	12	V DC
Power consumption	15	W
Dimension	349.20 x 283.40 x 39.95	mm
Weight	TBD	gram
VPE	5	
Remark	PCAP-Touch / high brightness / LED	

Power Input Connector

Type: DC Jack

Pin No.	Symbol	Description	Note
1	Vin	12V DC	Center
2	GND	GND	

Figure 1: Mechanical Outlines

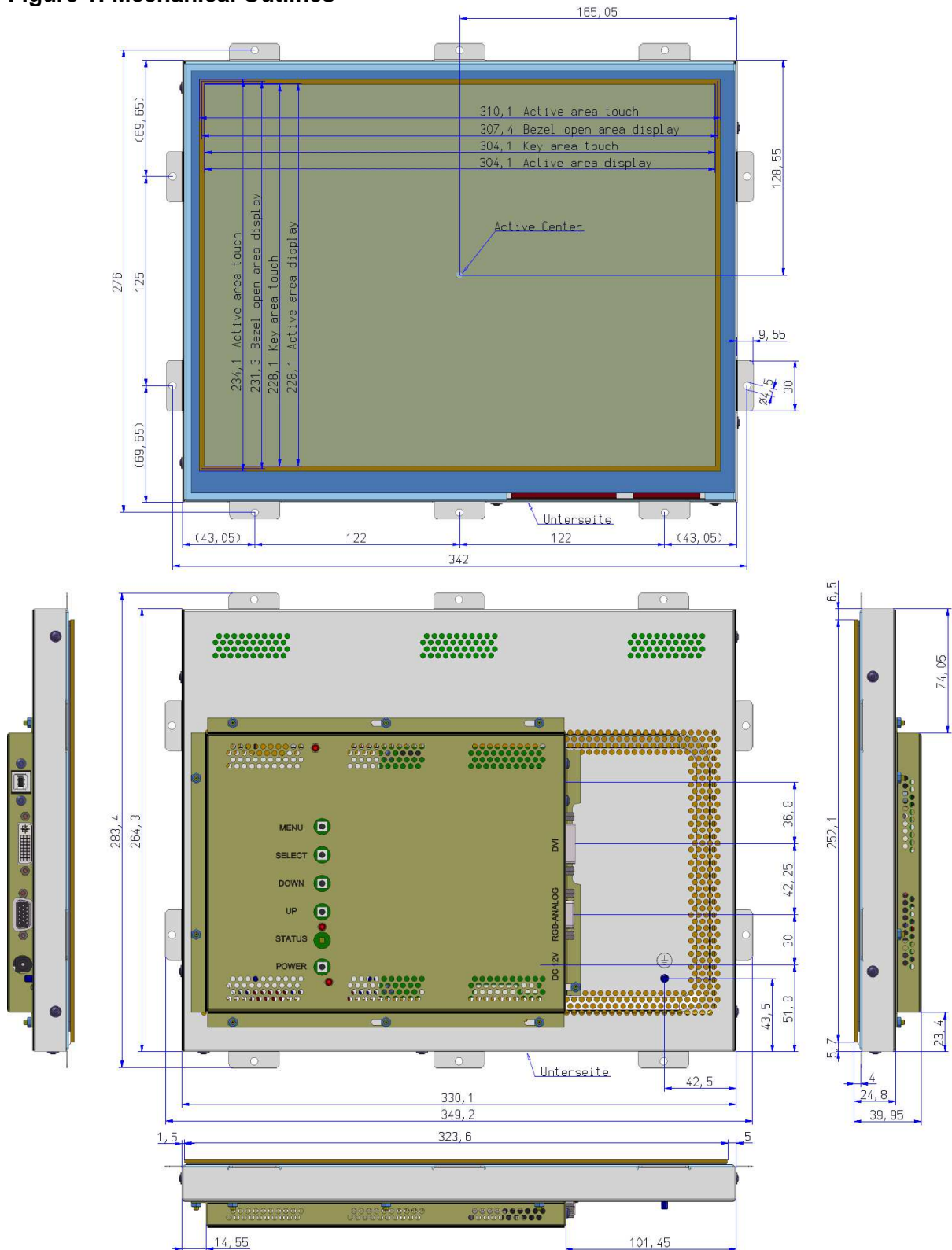

2. Handling & Cautions

Cautions when taking out the module

- Pick the pouch only, when taking out module from a shipping package.

Cautions for handling the module

- As the electrostatic discharges may break the LCD module, handle the LCD module with care. Peel a protection sheet off from the PCAP surface as slowly as possible.
- Do not use sharp material to clean the touch panel surface.
- If ketchup, food, or drinks drop on the surface, clean it immediately.
- It is necessary to prevent water from seeping into the touch panel from the perimeters during cleaning, especially the tail area.
- Put the module display side down on a flat horizontal plane.
- Handle connectors and cables with care.

Cautions for the atmosphere

- Dewdrop atmosphere should be avoided.
- Do not store and/or operate the LCD module in a high temperature and/or humidity atmosphere. Storage in an electro-conductive polymer-packing pouch and under relatively low temperature atmosphere is recommended.

Cautions for the module characteristics

- Do not apply fixed pattern data signal to the LCD module at aging time.
- Applying fixed pattern for a long time may cause image sticking.

Other cautions

- Do not disassemble and/or re-assemble LCD module.
- Do not re-adjust variable resistor or switch etc.
- When returning the module for repair or etc., please pack the module not to be broken. We recommend on using the original shipping packages.

3. Packing Information

Each of the five SCMT15X02-R is packed into an anti-static foil.

These five units of SCMT15X02-R are packed into a carton filled and cushioned with shock absorbing carton and therefore good protected for shipping on euro pallet.

4. Integration guide

The following illustration shows the standard integration method of mounting the SCMT-panel on your front bezel or system.

The edge from the front bezel opening should be placed between viewing area and active area of the touch panel.

PCAP touch screen is sensitive and highly susceptible to electrical noise. Common sources of noise include conductive front bezels or mechanics, EMI generated by electronic devices (especially high-frequency devices). Interference may result in false touch events. Thus, it is necessary to leave a gap between the touch panel and the bezel. Recommended gap distances are shown in following illustration.

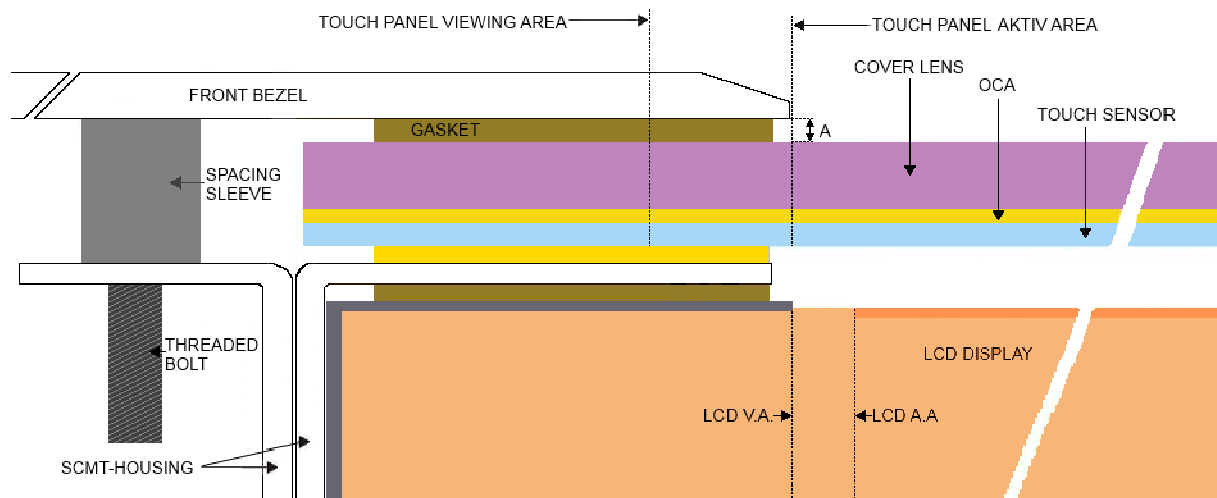

	Distance	Remarks
A	Non-conductive bezel: $\geq 0.5\text{mm}$ Conductive bezel: $\geq 1\text{mm}$	Distance after compressing the gasket or adhesive

The front gasket acts as a buffer when the touch panel is mounted to the front bezel. Single-sided adhesive non-conductive gasket is recommended for bonding with the touch panel. The front bezel must not come in contact with the surface of the touch panel.

The suggested thickness for the gasket is over 0.5mm (1.0 mm is recommended), except for special considerations or designs.

5. Optional Accessories

We refer to our webpage:

<http://beck-oled-lcd-tft-display.de/index.php?id=bcm-standard-line>

We offer a wide variety of optional accessories to operate the SCMT15X02-R.

6. Touchdriver download (PenMount PCI USB)

<http://www.amtouch.com.tw/downloads/penmount-drivers>